

**Note:**  
When site conditions require, wrap drainage tile in 3/4" aggregate and filter fabric with drainage composite or aggregate back drain system, as directed by geotechnical engineer.

**Typical Reinforced Wall Section**  
4" / 8" Century Wall Unit - Near Vertical Setback

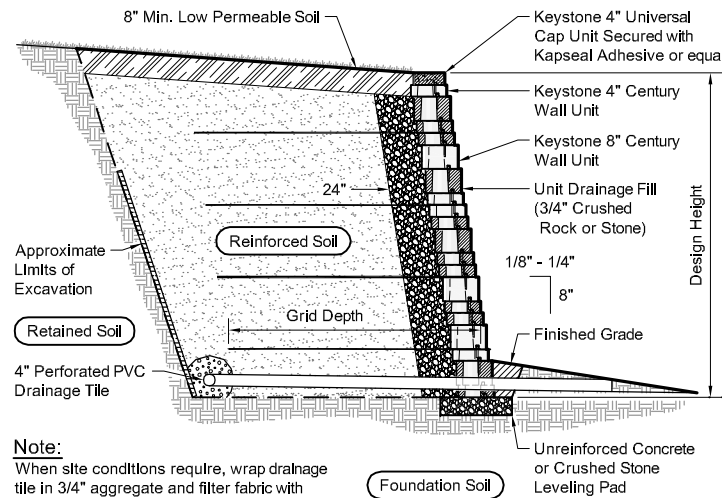

**Note:**  
When site conditions require, wrap drainage tile in 3/4" aggregate and filter fabric with drainage composite or aggregate back drain system, as directed by geotechnical engineer.

**Typical Reinforced Wall Section**  
4" / 8" Century Wall Unit - 1" Setback

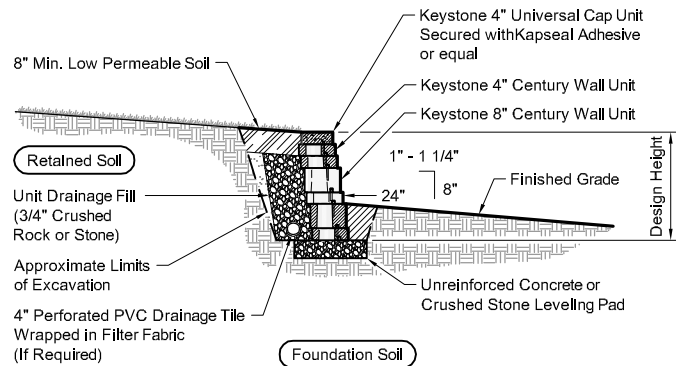

**Typical Gravity Wall Section**  
4" / 8" Century Wall Unit - 1" Setback

Large Unit	
Width:	18"
*Depth:	12"
Height:	4"/8"
*Weight:	46/93 lbs
Medium Unit	
Width:	11"
*Depth:	12"
Height:	4"/8"
*Weight:	29/58 lbs
Small Unit	
Width:	7"
*Depth:	12"
Height:	4"/8"
*Weight:	18/37 lbs

**Base Leveling Pad Notes:**  
1. The leveling pad is to be constructed of crushed stone or 2,000 psi unreinforced concrete  
2. The base foundation is to be approved by the site geotechnical engineer prior to placement of the leveling pad.

Universal Cap Unit	
Width:	18"/12"
*Depth:	10 1/2"
Height:	4"
*Weight:	49 lbs

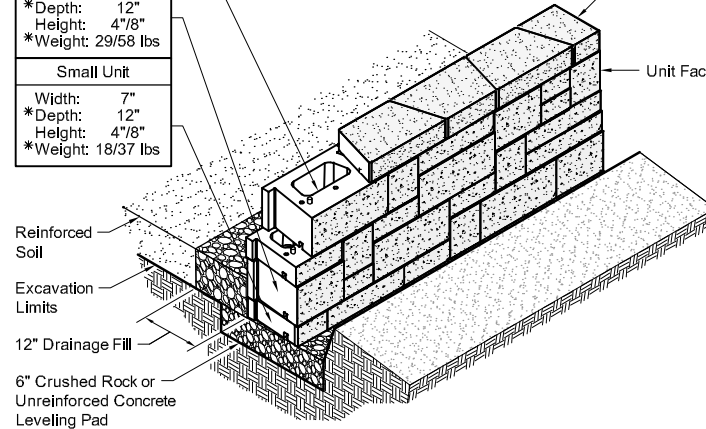

**Century Wall Unit/Base Pad Isometric Section View**  
\* Dimensions & Weight May Vary by Region

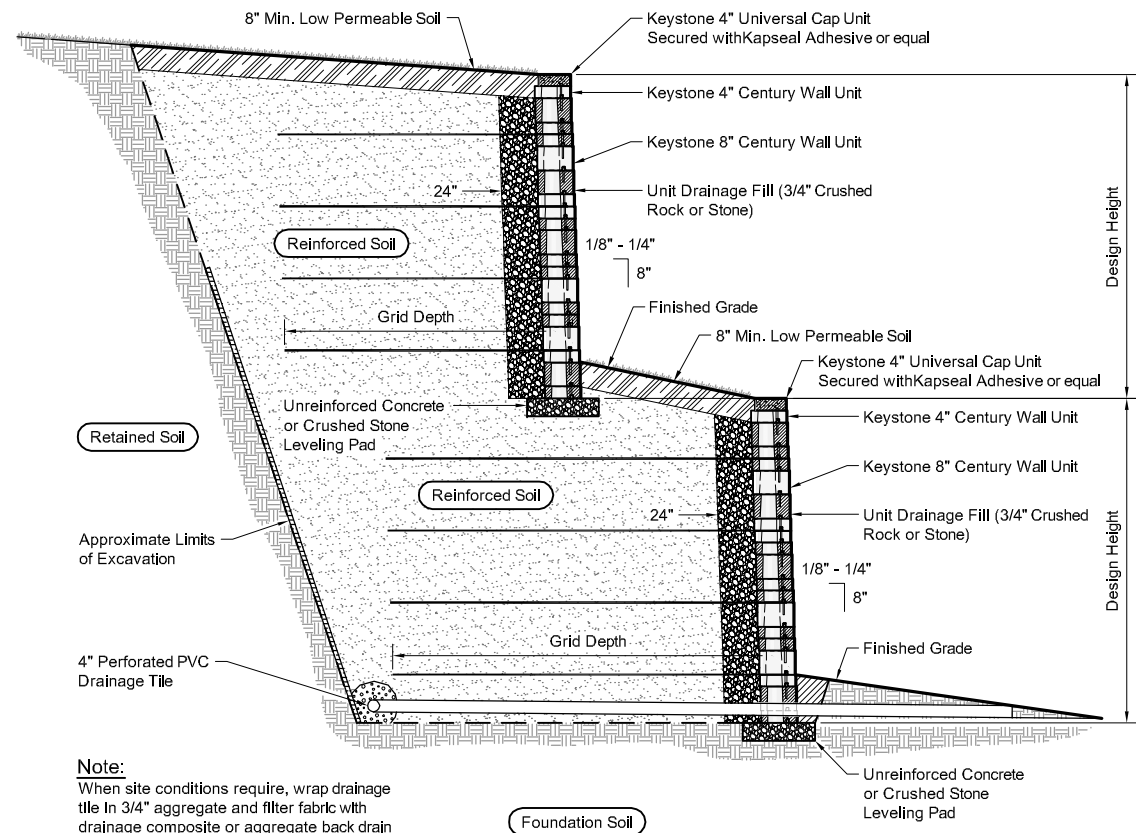

**Note:**  
When site conditions require, wrap drainage tile in 3/4" aggregate and filter fabric with drainage composite or aggregate back drain system, as directed by geotechnical engineer.

**Typical Reinforced Tiered Wall Section**  
4" / 8" Century Wall Unit - Near Vertical Setback

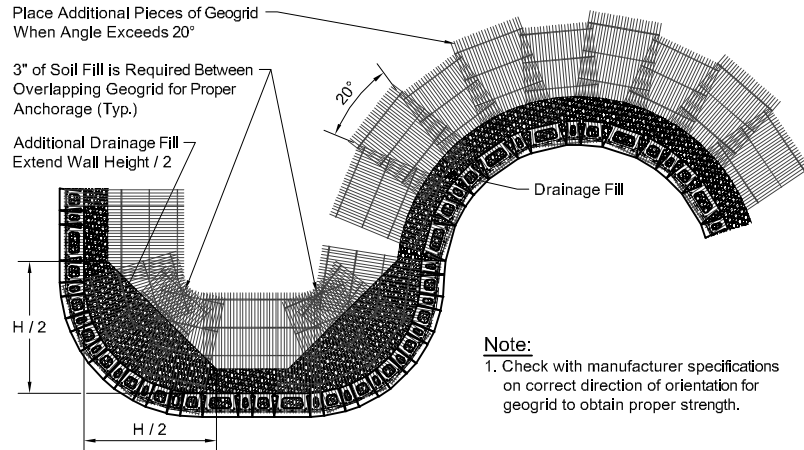

**Geogrid Installation on Curves**

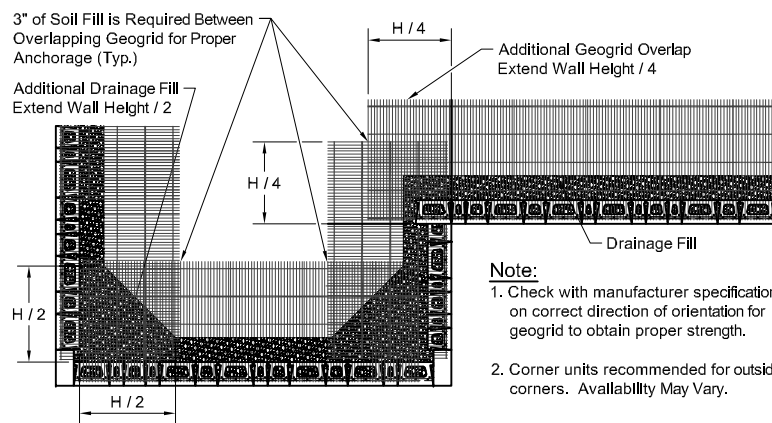

**Geogrid Installation at Corners**

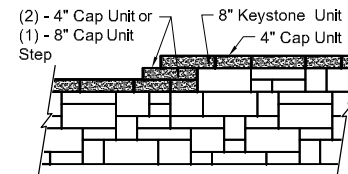

**Note:**  
1. Secure all cap units with Keystone Kapseal or equal.

**Top of Wall Steps**

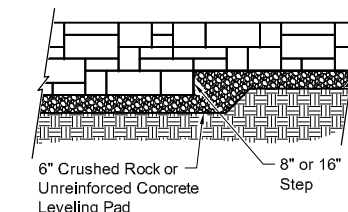

**Note:**  
1. The leveling pad is to be constructed of crushed stone or 2000 psi ± unreinforced concrete.

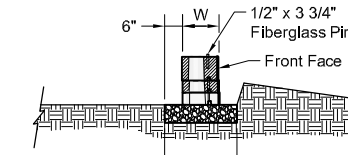

**Leveling Pad Detail**

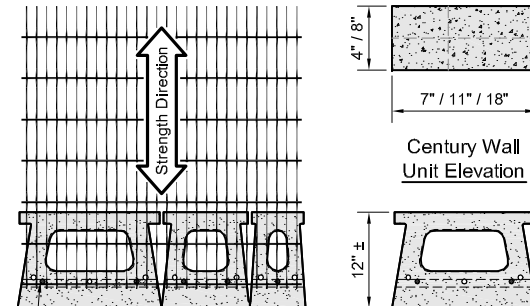

**Large Unit Plan**

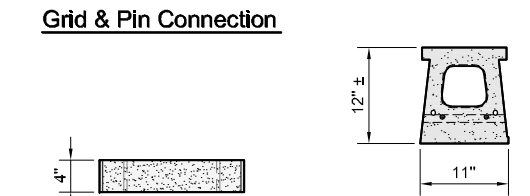

**Medium Unit Plan**

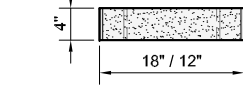

**Cap Unit Elevation**

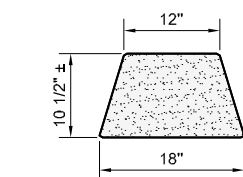

**Cap Unit Plan**

**Universal Cap Unit**

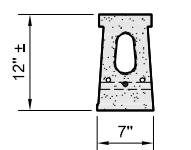

**Small Unit Plan**

**Century Wall Unit**

Copyright 2005 Keystone Retaining Wall Systems

Design is for internal stability of the KEYSTONE wall structure only. External stability, including but not limited to foundation and slope stability is the responsibility of the Owner. The design is based on the assumption that the materials within the retained mass, methods of construction, and quality of materials conform to KEYSTONE's specification for this project.

This drawing is being furnished for this specific project only. Any party accepting this document does so in confidence and agrees that it shall not be duplicated in whole or in part, nor disclosed to others without the consent of Keystone Retaining Wall Systems, Inc.

No.	Date	Revision	By



Designed By: RKM	Title: 4" / 8" Century Wall Unit - Details	Date:
Checked By: CDM	Project: Keystone Retaining Wall Systems Typical Wall Details	Project No:
Scale: No Scale		Drawing No: